

Lehman -
PIKE
✓

No 15

D. 86-19.

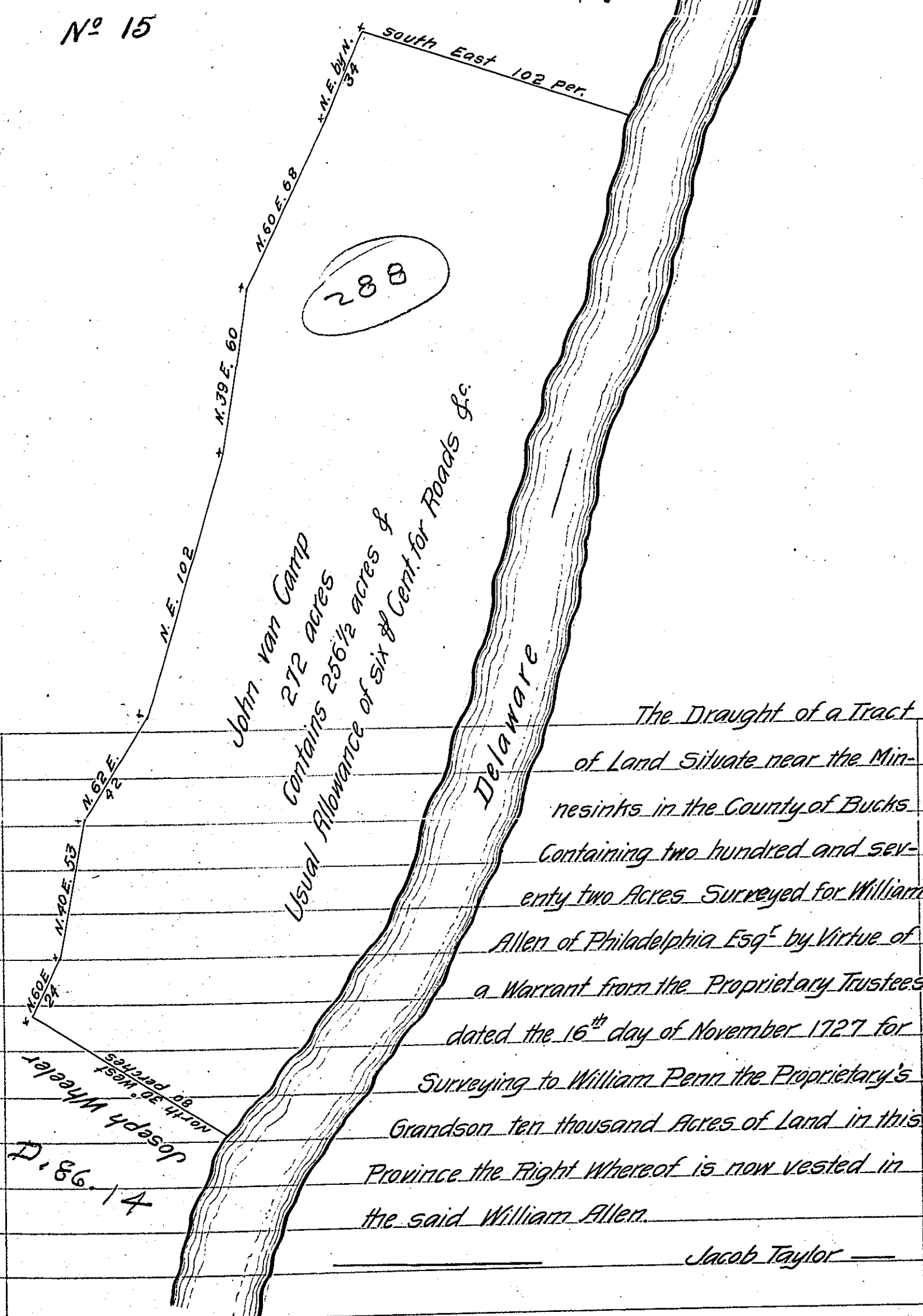

John van Camp
272 acres
Contains 256 1/2 acres &
Usual Allowance of six & Cent for Roads &c.

Delaware

The Draught of a Tract

of Land Situate near the Min-
nesinks in the County of Bucks
Containing two hundred and sev-
enty two Acres Surveyed for William
Allen of Philadelphia Esq^r by Virtue of
a Warrant from the Proprietary Trustees
dated the 16th day of November 1727 for
Surveying to William Penn the Proprietary's
Grandson ten thousand Acres of Land in this
Province the Right Whereof is now vested in
the said William Allen.

Jacob Taylor

D. 86-14
Joseph Wheeler

IN TESTIMONY that the above is a copy of the original remaining on file in
the Department of Internal Affairs of Pennsylvania, made
conformably to an Act of Assembly approved the 16th day of
February, 1833, I have hereunto set my Hand and caused
the Seal of said Department to be affixed at Harrisburg,
this sixth day of February 1911.

Henry Houch
Secretary of Internal Affairs.